

Proposal for e-tender document on

Comprehensive AMC (CAMC) of CCTV camera surveillance system at CSIR-CMERI institute and CMERI Colony premises.

PURPOSE & SCOPE OF WORK:

The following number of CCTV cameras have installed at different locations at CMERI Colony and institute premises in Phase-II & Phase-III as given in **Table 1**.

Table 1. Total No of Installed cameras (Locations)

S No	Total No of Installed cameras (Locations)	Numbers
1.	At CMERI Colony	27 Nos
2.	At CMERI institute	28 Nos
	Total	55 Nos

The comprehensive AMC of CCTV camera surveillance system at both the places (CMERI Colony and CMERI institute premises) are required where total number of 55 Nos are installed.

The following items will be considered under compressive AMC:

1. **Total CCTV camera : 55 Nos.** The detail of each camera are given below;

S No	Type of Camera	Numbers	Make	Locations
1.	3 MP IP Bullet Camera	21 Nos	Honeywell	The detail of each location is mentioned in annexure-I.
2.	3 MP IP Bullet Camera	24 Nos	Matrix	
3.	2 MP IP Bullet Camera	04 Nos	Hikvision	
4.	4 MP IP Bullet Camera	01 Nos	Hikvision	
5.	4 MP IP Bullet Camera	03 Nos	Dauha	
6.	2 MP IP Bullet Camera	02 Nos	Armored	

2. **Network video recording (NVR):** The detail of each NVR are given below;

S No	NVR	Numbers	Make	Locations
1.	24 Channel NVR with voice recording	02 Nos	Matrix	• One installed at CMERI colony (check post)



	features			<ul style="list-style-type: none"> One installed at institute (Security gate)
2.	16 Channel NVR	02 Nos	Honey well	<ul style="list-style-type: none"> One installed at CMERI colony (check post) One installed at institute (Security gate)

3. **Mounting 4-U racks** : 04 Nos (2 Nos at CMERI Colony and 02 Nos at institute premises)

4. **Surveillance Hard Disks:**

S No	Type of Hard Disk and Capacity	Make	Numbers	Locations
1.	Surveillance HDD, 4 TB	Seagate	04 Nos	2 Nos at CMERI Colony 2 Nos at institute premises
2.	Surveillance HDD, 6 TB	Seagate	04 Nos	2 Nos at CMERI Colony 2 Nos at institute premises

4. **Support items:** The support items are installed at each camera installed locations like Media convertor, 4port/8port/24 port switches, SMPS, patch cord, OFC junction boxes, IP junctions boxes, poles, PDU, OFC patch cord, cat6, power cable, OFC cable, Audio bug, adopters, DC jack etc.

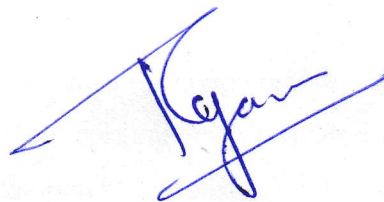

Term and conditions

General Terms & Conditions:

The Comprehensive AMC will include

1. Maintenance of all the CCTV cameras installed in the CMERI institute and Colony which is having fixing stands, weatherproofing arrangements for the cameras, video NVRs, media converter and its power supply arrangement as per listed in purpose and scope of work column.
2. Maintenance of cable connectivity between cameras located at different locations shall include maintenance of cable, termination device, fixing rack, network device/ network cable etc. and their power supply arrangements at the camera end and also includes maintenance of media converter, termination device, network switches etc and their power supply arrangements.
3. This CAMC will include repairs, replacement of defective components with the new one to ensure trouble free and efficient service of equipment during the contract period. Any problem arising due to hardware defect, software problem will be covered in the maintenance. In case an equipment or part thereof is taken for repair, responsibility of restoring the back-up data will be borne by the vendor. The losses will be compensated by the vendor.
4. Preventive maintenance of all items which will include cleaning of all the equipments, checking individual and complete performance of the equipments of the CCTV system.
5. Preventive maintenance will include monitoring the conditions in which the hardware is working and forewarning the in-charge of any factors detrimental to the satisfactory functioning of the hardware.
6. The responsibility of backup and retrieval of data during maintenance and service of the equipment will be with the firm.
7. The vendor shall consider the CCTV system and equipments along with it such as the network device, power supply arrangement, recording devices etc as a whole except monitors and ensure proper working of all the equipment for ensuring effective functioning of the CCTV system.



8. This will also include the troubleshooting of any network issues arising in the CCTV network.
9. The preventive maintenance visit should be done once in a month apart from service calls.
10. The entire CCTV based surveillance system should be in live condition after taking over of the project. No extra cost will be paid for restoring purpose. Any faulted items should be replaced without any extra cost.
11. Before quoting the offer, the vendor should do physical inspection of CCTV camera setup at both the places (CMERI Colony and CMERI institute premises). The physical inspection will be done within 5 days after placing e-tender in website <http://etenders.gov.in>.
12. The CCTV camera based surveillance system should run 24x7 at both places (CMERI Colony and institute premises).

Resident Engineers:

13. The vendor will depute at least one qualified resident engineer/technician (ITI/Diploma/Certification course in relevant field like CCTV surveillance system) with experience of at least two years in this field who will work on the contract period during institute working days (Monday to Fridays) with timing 9.30 AM-6.00 PM.
14. The resident engineer may be called on holidays (like Saturday and Sunday) or after office hours on urgent basis. During availing the leave of resident engineer, the substitute of resident engineer will be provided.
15. The engineer should have sufficient and requisite knowledge of maintenance and trouble shooting of the CCTV system.
16. The deployed engineer should be dedicated for maintenance of CCTV surveillance system and will report to the Security Officer at CSIR-CMERI, Durgapur. The sitting arrangement for resident engineer can be made in Security office of Main Gate at CSIR-CMERI, Durgapur. The resident engineer will look after CCTV camera based surveillance system of CMERI Colony and CMERI institute premises.
17. The vendor shall provide a mobile phone to the engineer for easy accessibility.

Period of Contract:



18. The contract is valid for two years from the date of signing of the contract.

Payment Terms:

19. For all CAMC, the payment will be made on quarterly basis (25% of order value of CAMC) after completion of the said quarter, subject to their satisfactory performance, to be certified by Security officer and Head IT Division.

20. A quarterly maintenance chart should be maintained and get it signed from Security officer and Head IT Division for releasing the payment timely.

Replacement of Parts:

21. Any damage of OFC and power cable will also be repaired within under CAMC which is installed at underground conditions at both places. During any damage of OFC, the splicing and repair work of OFC has to be done by vendor at their cost.

22. Spare parts supplied by vendor in lieu of irreparable components should be brand new/original/equivalent/advanced make and from reputed manufacturers for giving satisfactory performance. Used/repaired spare parts will not be accepted.

23. If systems/subsystems are required to be taken out of office for repairing, then a stand-by system/subsystem of the similar configuration and quality acceptable to this office will be provided on returnable basis. The vendor will be responsible for transportation and delivery of systems/subsystems. Such items under repair, should be returned and repaired upto the satisfaction of user with consultation of IT Division within a period of maximum ten days.

24. Free replacement should be provided in case of any defect/fault/failure in any spare related to CCTV system during contract period.

Response Time:

25. The system down time should not exceed 24 hours from the time at which the complaint was made. If the downtime is more than 24hours, the vendor will provide a standby system. In case the system is not repaired or an alternate system is not provided within 24 hours from the time of failure report, then the institute may choose to get the same repaired or replaced from any other agency and the cost and expenditure incurred therein shall be recoverable from the vendor.



26. The call should be attended within 24 hrs in case any technical problems.

27. Attending to breakdown call on urgent basis.

Reporting Authority:

28. The service engineer will be allowed to handle the respective equipment only as normal procedure of Security Office.

Service Register:

29. The vendor would be required to maintain a call /service register, both at his end and at the institute, along with the call report, giving details of the maintenance work done and the downtime of the equipment. The register will have the following details

- a) Name of the Equipment.
- b) Date of periodical maintenance.
- c) Due date of the next periodical maintenance.
- d) Nature of defect noticed.
- e) Details of the repair work done with date.
- f) Name of the service engineer and signature.
- g) Name of the officer in-charge (Security Officer) from the Institute with signature.

Others:

1. Vender should have GST./ PAN No./TDS No and other supporting document to establish that the vendor has adequate experience in maintenance of CCTV systems.
2. The vender shall have experience of minimum 3 Years in similar field of AMC with executions of minimum one project of Rs 3.00 Lakhs along with Government/Semi-Government/Government Undertaking/Autonomous organizations.
3. The map of installed the CCTV camera will be provided by CMERI.



Annexure-I

Total List of CCTV camera based surveillance system in the institute and CMERI Colony

	CMERI Colony	Institute
Phase-II	<u>Without voice recording features:</u>	<u>Without voice recording features:</u>
	1. Main gate of Colony : 01 Nos Make: Hivkision	1. Near R & A Group Position : 02 Nos Make: Honeywell
	2. Security Post of main gate : 01 Nos Make: Hivkision (4 MP)	2. Canteen Dining Hall : 01 Nos Make: Honeywell
	3. Director Bungalow : 01 Nos Make: Hivkision	3. Backside of Canteen : 01 Nos Make: Honeywell
	4. MSW site : 01 Nos Make: Hivkision	4. P4 to onward Mechatronics School : 01 Nos Make: Honeywell
	5. Executive Hostel : 01 Nos Make: Hivkision	5. Administrative Corridor : 01 Nos Make: Honeywell
	6. Sallow Basin site : 02 Nos Make: Armored	6. MM Suri Hall Corridor : 02 Nos Make: Honeywell
	7. Staff Club Entrance Gate : 01 Nos Make: Honeywell	7. Near Garage to onward Chemistry building: 01 Nos Make: Honeywell
	8. Executive Hostel Dining Hall : 01 Nos Make: Honeywell	8. Near AdMaC to onward to backside road : 01 Nos Make: Honeywell
	9. Old Guest House Gate : 01 Nos Make: Honeywell	9. Towards Receiving store : 01 Nos Make: Honeywell
	10. 96 Staff (New Colony) Gate : 01 Nos Make: Honeywell	10. Near CAMP to onward-P4 backside road : 01 Nos Make: Honeywell
	11. SBI Gate : 01 Nos Make: Honeywell	11. P4 onward Mechatronics School : 01 Nos Make: Honeywell
	12. Dispensary Waiting Hall : 01 Nos Make: Honeywell	12. Back Gate for monitoring security post : 01 Nos Make: Honeywell
	13. Top of Solar artifact : 01 Nos Make: Dauha	13. Solar Park : 01 Nos Make: Honeywell
	Subtotal (A) : 14 Nos	14. Canteen inside : 02 Nos Make: Dauha Subtotal (C) : 17 Nos
Phase-III	<u>With Audio features:</u>	<u>With Audio features:</u>
	1. A-Row onward to guest House : 01 Nos Make: Matrix	1. Onward Main building Road : 01 Nos Make: Matrix
	2. From A-Row onwards to temple Road : 01 Nos Make: Matrix	2. From R&A Group to Main building Road : 01 Nos Make: Matrix
	3. Near Temple : 01 Nos Make: Matrix	3. Onward Chemistry Building to NDT Road : 01 Nos Make: Matrix
	4. Onward Children park to MS Building Road:01Nos Make: Matrix	4. From P-4 road to Onwards AdMaC Road : 01 Nos Make: Matrix
	5. MS Building Road to Onward Children park: 01Nos Make: Matrix	5. From P-4 road to Onwards CAMP Road :01 Nos Make: Matrix
	6. Onward ceremony Bungalow to Dispensary Road: 01 Nos Make: Matrix	6. Near MOB Building :01 Nos Make: Matrix
	7. Dispensary onward to M-Row : 01 Nos Make: Matrix	7. From Main Gate onward to Back Gate :01 Nos Make: Matrix
	8. Onward Maintenance office to M-Row : 01 Nos Make: Matrix	8. From Back Gate onward to Main Gate :02 Nos Make: Matrix
	9. In front of Maintenance office : 01 Nos Make: Matrix	9. Solar Park :01 Nos Make: Matrix
	10. MSW Site : 01 Nos Make: Matrix	10. Cultivation site (without Audio) :01 Nos Make: Matrix
	11. Guest House premise : 02 Nos Make: Matrix	Subtotal (E) :11 Nos



12. New Colony Gate (without Audio)	: 01	
Nos Make: Matrix		
Subtotal (B)	: 13	
Nos		
Subtotal (A+B)= 27 Nos		Subtotal (C+D)= 28 Nos
Total (A+B+C+D)		55 Nos

Regun

Layout of CCTV network system: CMERI Colony

Layout of CCTV camera in the CMERI colony

Total 64 CCTV Camera installed in CSIR-CMERI, INSTITUTE & COLONY Premises.

CMERI COLONY	
1-Main gate of colony	: 01 No
2-Security post of main gate	: 01 Nos
3-Director bungalow	: 01 Nos
4-MSW site	: 01 Nos
5-Executive hostel	: 01 Nos
6-Shallow basin site	: 02 Nos
7-Staff club entrance gate	: 01 Nos
8-Executive hostel dining hall	: 01 Nos
9-Old Guest house gate	: 01 Nos
10-96 Staff (New colony) gate	: 01 Nos
11-SBI gate	: 01 Nos
12-Dispensary waiting hall	: 01 Nos
13-Top of solar artefact	: 01 Nos
Subtotal (D)	: 14 Nos

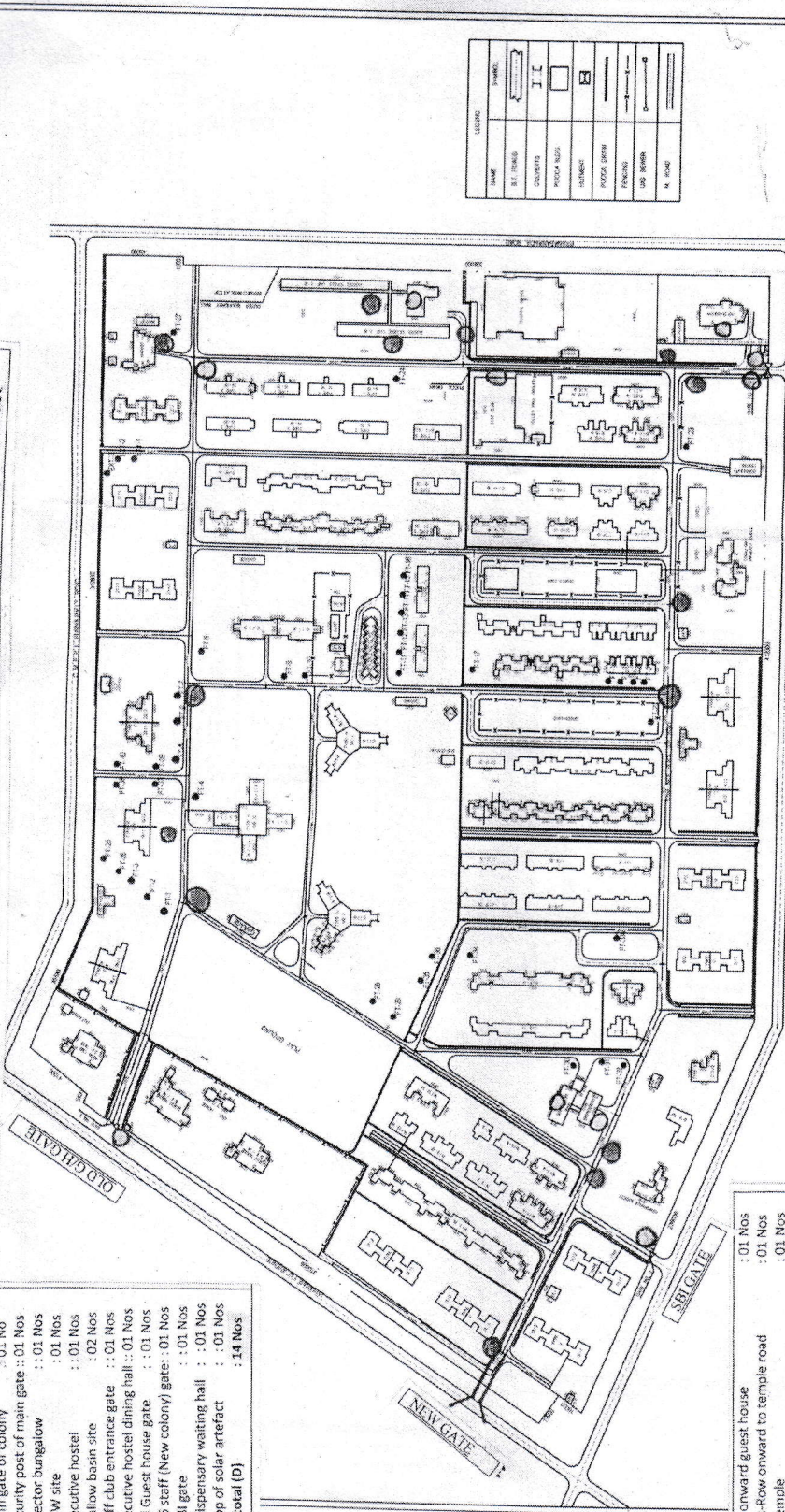

NAME	SYMBOL
ALL BUILDING	[Symbol]
COLONNATE	[Symbol]
PERVAH ROAD	[Symbol]
WATERMANT	[Symbol]
POSSIBLE DRIVE	[Symbol]
PERVAH	[Symbol]
ROAD NUMBER	[Symbol]
N. ROAD	[Symbol]

AREA STATEMENT
TOTAL LAND AREA : 2077.50 SQ.M.
TOTAL LAND AREA : 51.96 ACRES

MASTER PLAN OF CSIR-CMERI, MECHANICAL ENGINEERING RESEARCH INSTITUTE STAFF QUARTERS COLONY (S.Q.)
PROPOSED NO. OF BUILDINGS : 100 (NO. OF F.)
General Mechanical Engineering Research Institute

NO.	DATE	REVISION

AB BUNGALOW GATE

96 GATE

SHALLOW BASIN SITE

TOTAL CAMERA INSTALLED IN CMERI COLONY + Top:	
Phase-I	14
Phase-II	13
TOTAL	27
CH	27+37 = 64

Inst + colony

1-A-Row onward guest house	: 01 Nos
2-From A-Row onward to temple road	: 01 Nos
3-Near temple	: 01 Nos
4-Onward children park to MS building road	: 01 Nos
5-MS building road to onward children park	: 01 Nos
6-Onward ceremony bungalow to dispensary road	: 01 Nos
7-Dispensary onward to M-row	: 01 Nos
8-Onward maintenance office to M-row	: 01 Nos
9-In front of maintenance office	: 01 Nos
10-MSW site	: 02 Nos
11-Guest house premises	: 01 Nos
12-New colony gate	: 01 Nos
Subtotal (E)	: 13 Nos

Layout of CCTV network system: Institute

Layout of CCTV camera in the Institute

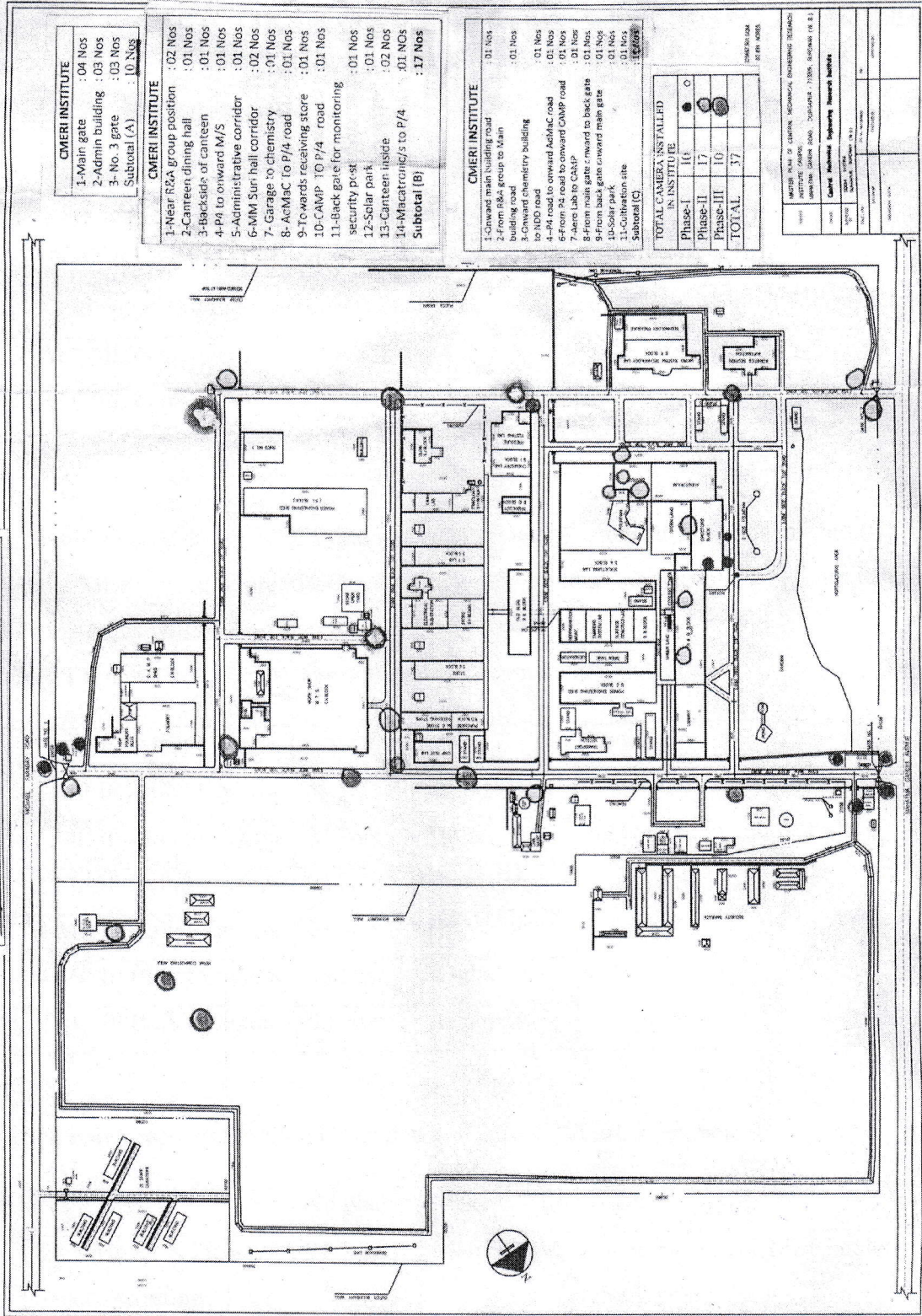

CMERI INSTITUTE

1-Main gate	: 04 Nos
2-Admin building	: 03 Nos
3-No. 3 gate	: 03 Nos
Subtotal (A)	: 10 Nos

CMERI INSTITUTE

1-Near R&A group position	: 02 Nos
2-Canteen dining hall	: 01 Nos
3-Backside of canteen	: 01 Nos
4-P4 to onward M/S	: 01 Nos
5-Administrative corridor	: 01 Nos
6-MM Suri hall corridor	: 02 Nos
7-Garage to chemistry	: 01 Nos
8-AcMac to P/4 road	: 01 Nos
9-To wards receiving store	: 01 Nos
10-CAMP TO P/4 road	: 01 Nos
11-Back gate for monitoring security post	: 01 Nos
12-Solar park	: 01 Nos
13-Canteen inside	: 02 Nos
14-Macaronic/s to P/4	: 01 Nos
Subtotal (B)	: 17 Nos

CMERI INSTITUTE

1-Onward main building road	: 01 Nos
2-From R&A group to Main building road	: 01 Nos
3-Onward chemistry building to NDD road	: 01 Nos
4-P4 road to onward AcMac road	: 01 Nos
5-From P4 road to onward CAMP road	: 01 Nos
6-From Lab to C&E toward back gate	: 01 Nos
7-From back gate toward main gate	: 01 Nos
8-Solar park	: 01 Nos
11-Cultivation site	: 01 Nos
Subtotal (C)	: 11 Nos

TOTAL CAMERA INSTALLED IN INSTITUTE

Phase-I	16
Phase-II	17
Phase-III	10
TOTAL	37

CMERI INSTITUTE

DATE	
SCALE	
PROJECT	
DESIGNER	
CHECKER	
APPROVED	

Total 64 CCTV Camera installed in CSIR-CMERI, INSTITUTE & COLONY Premises.